

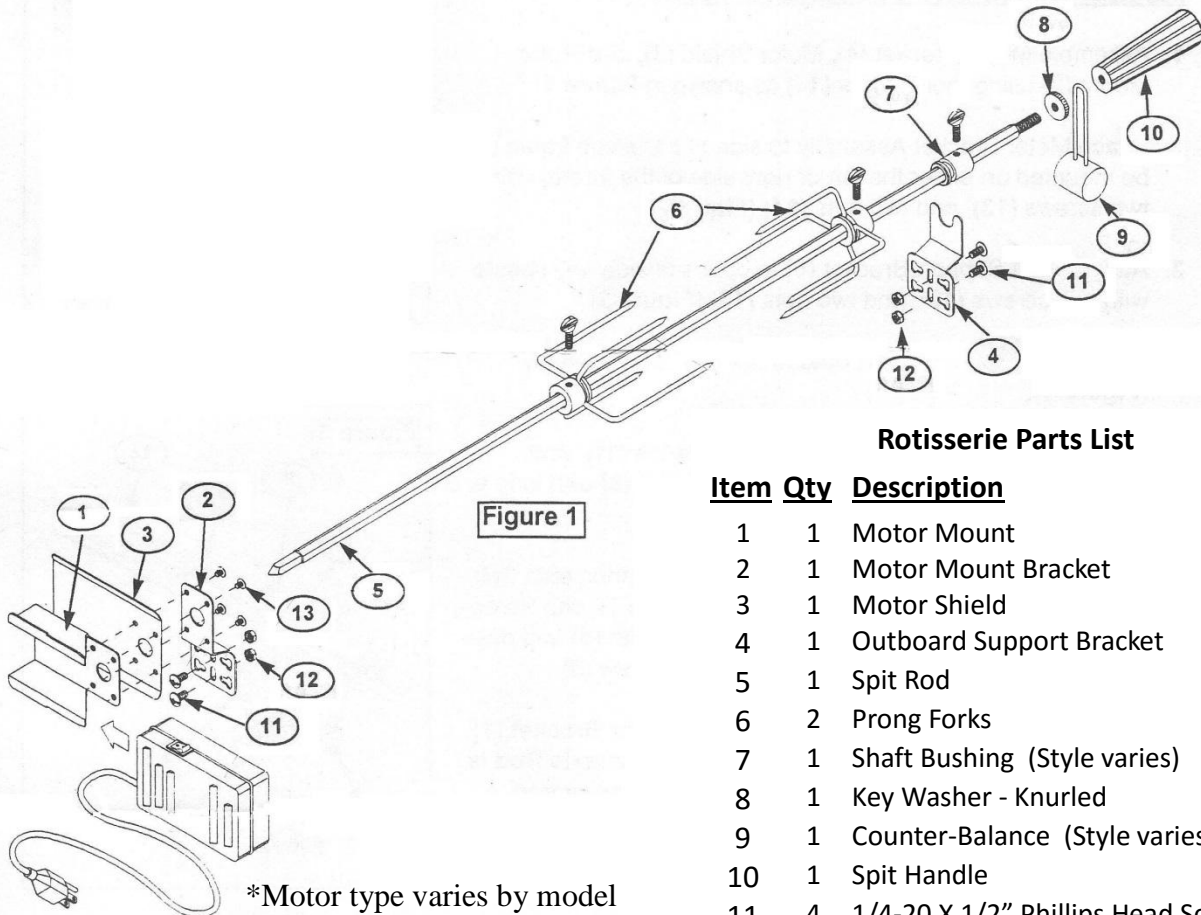

## COMPLETE ROTISSERIE ASSEMBLY INSTRUCTIONS



### Rotisserie Parts List

Item	Qty	Description
1	1	Motor Mount
2	1	Motor Mount Bracket
3	1	Motor Shield
4	1	Outboard Support Bracket
5	1	Spit Rod
6	2	Prong Forks
7	1	Shaft Bushing (Style varies)
8	1	Key Washer - Knurled
9	1	Counter-Balance (Style varies)
10	1	Spit Handle
11	4	1/4-20 X 1/2" Phillips Head Screw
12	4	1/4-20 Nut
13	4	M4 X 6mm Phillips Head Screw

### FOR YOUR SAFETY PLEASE READ ALL INSTRUCTIONS PRIOR TO USE!

- Surfaces will become hot during use. Use handle or mitts.
- To protect against electrical shock, do not immerse motor, cord or plug in water or other liquid.
- Close supervision is necessary when appliance is used by or near children.
- Unplug from outlet when not in use and before cleaning. Allow to cool before adding or taking off parts.
- Do not operate any appliance with a damaged cord or plug, or after the appliance malfunctions or has been damaged in any manner. Return appliance to the nearest authorized service facility for examination, repair, or adjustment.
- The use of accessory attachments not recommended by the appliance manufacturer may cause injuries.
- Do not let cord hang over edge of table or counter, or touch hot surfaces.
- Do not place on or near a hot gas or electric burner, or in a heated oven.
- Extreme caution must be used when moving an appliance containing hot oil or other hot liquids.
- Always attach plug to appliance first, then plug cord into the wall outlet. To disconnect, turn any control to "OFF", then remove plug from wall outlet.
- Do not use appliance for other than intended use.



## COMPLETE ROTISSERIE ASSEMBLY INSTRUCTIONS

1. Assemble Motor Bracket (2), Motor Shield(3), and Motor Mount (1) using four screws (13) as shown in **Figure 1**. **\*\*CAUTION\*\* Do not mount motor mount directly to grill. Motor will fail prematurely.**
2. Attach Motor Bracket Assembly to side of barbecue frame (can be mounted on either the left or right side of the frame) using two screws (11) and two nuts (12) as shown in **Figure 2**.
3. Attach Outboard Support Bracket (4) to opposite side and secure with two screws (11) and two nuts (12) as shown in **Figure 3**.
4. Insert Rotisserie Motor onto Motor Bracket Assembly as shown in **Figure 1**.
5. Assemble Key Washer (8), Counterbalance (9), and Handle (10) to Spit Rod (5). Slide Shaft Collar (7) with end towards Handle as shown in **Figure 3**.
6. Slide Prong Forks (6) onto Spit Rod (5). Place food onto Spit Rod and secure with Prong Forks. Secure with thumb screws. Place Spit Rod assembly over Shaft Bracket (4) and position into Motor. Secure position with Shaft Bushing; tighten thumbscrew/screw.
7. Close barbecue hood carefully and align the Motor Bracket(1) and Shaft Mounting Bracket (4) so that the Spit Rod is centered in the lid openings allowing 1/16" clearance to allow Spit Rod to turn see **Figure 4**.
8. Ensure that all screw/nuts are tightened securely.

**\*\*Cooking Grates are typically removed from barbecue for all rotisserie cooking. On select grills you can remove only the center grill grate, keeping the side grates in place. This configuration allows for steaming pans or smoke trays.**

**\*\*To avoid flare up, drip trays are recommended for rotisserie cooking.**

### WARRANTY

This OneGrill™ Product is covered under the OneGrill™ 1 year "No Hassle Warranty". If, for any reason, this product fails when used as prescribed within 1 year from the date of purchase, we will repair or replace the item(s) at no additional cost to you the consumer. Proof of purchase required. Certain restrictions may apply.

**Thank you for choosing ONEGRILL™**

